

HOLE # : **N0903****TROYMET EXPLORATION CORP.
GOLDEN EAGLE PROJECT
DIAMOND DRILL LOG**HOLE # : **N0903**

UTM Coordinates NAD 83, Zone 8

Collar Survey Type: **Garmin hand held GPS**Northing : **6642215**Easting : **507731**Elevation (m) : **1360 m.**Hole Length : **137.16 m**Azimuth (true) : **120**Dip : **-65**

NTS : 104M/15

Core Size: **NTW**Overburden : **3.05 m**

Contractor : Kluane Drilling Ltd

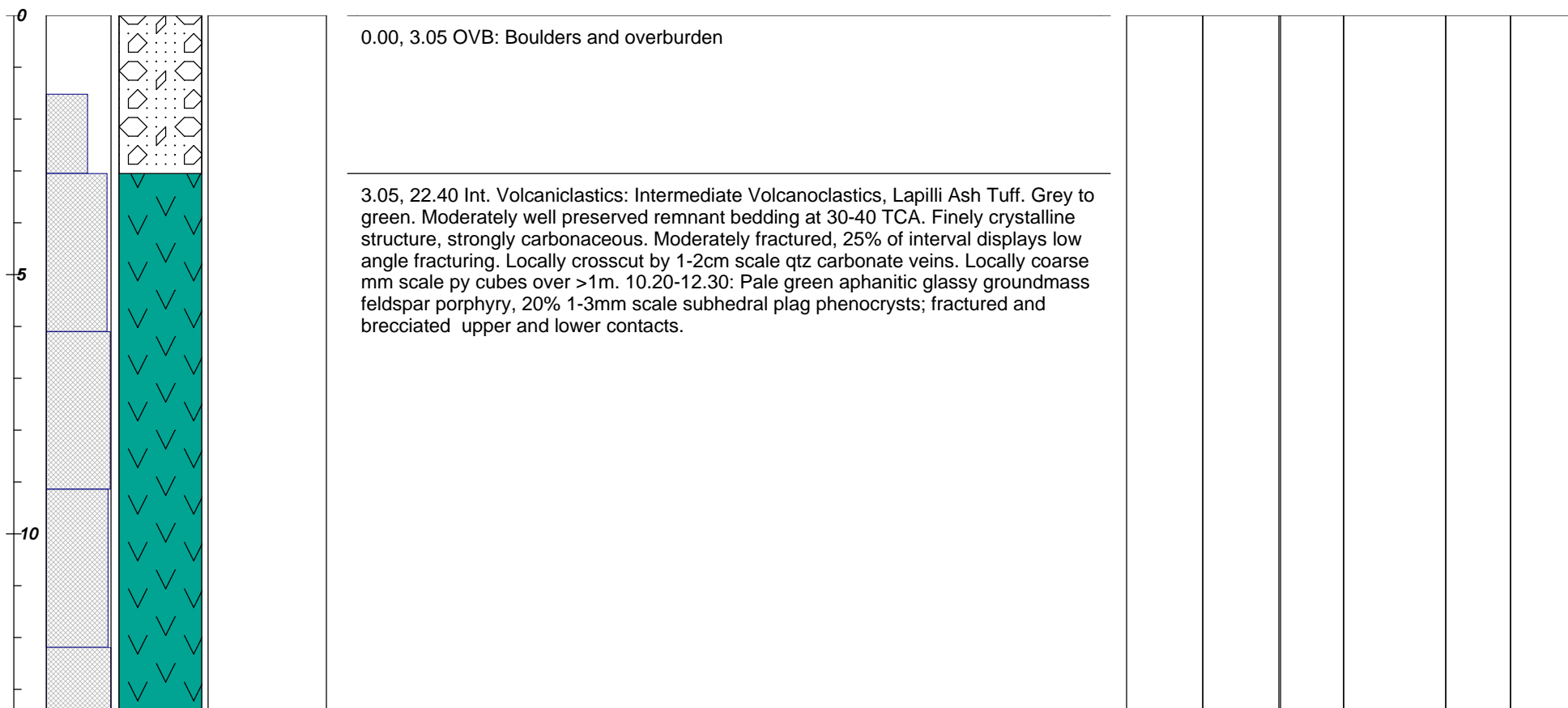
Logged By : **Derek Torgerson**Date Hole Started : **October 10, 2009**Date Hole Completed : **October 11, 2009****Sulphide Mins**— pyrite
— chalcopyrite
— arsenopyrite**Recovery**
0 % 100%
0% 10%
From To
(m) (m)**DESCRIPTION****Sample Data**
From To Wdth Sample Au Ag
(m) (m) (m) (g/t) (g/t)

TROYMET EXPLORATION CORP.
GOLDEN EAGLE PROJECT
DIAMOND DRILL LOG

Depth (m)	Recovery		Sulphide Mins		From (m)		To (m)	DESCRIPTION	Sample Data					
	0 %	100%	0%	10%					From (m)	To (m)	Width (m)	Sample	Au (g/t)	Ag (g/t)
15								14.20, 16.70 1% coarse remobilized pyrite cubes qtz carbonate veinlets.	14.20	15.40	1.20	I006163	0.027	0.4
									15.40	16.70	1.30	I006164	0.018	0.5
20														
25								22.40, 130.94 Argillite: Carbonaceous Argillaceous Siltstone. Dark Grey to Black. Very fine grained compact structure. Locally moderately well preserved remnant bedding at 65-70 TCA. Strongly tectonized with >2m scale sections very fractured and shattered, well healed with late brecciated and boudinaged white qtz carbonate veins carrying py, po, cpy and rarely aspy. Locally brecciated. More brecciated sections display localized soft sediment deformation. Interval is characterized as a high strain zone with multiple phases of ductile and brittle deformation. Below 54.27 becomes silicified with ductile deformation more prevalent and expressed as folded and boudinaged qtz carbonate veining. Locally preserved zones of brown biotite alteration and contact metasomatism of bright forest green actinolite. Sulphide mineralization increases downhole with po, py, cp, aspy, gn, and sph. Selected sections are very bleached with in situ alteration to a mottled textured quartzite (?), moderately magnetic containing 1-2% very fine mte.						
30														

TROYMET EXPLORATION CORP.
GOLDEN EAGLE PROJECT
DIAMOND DRILL LOG

Depth (m)	Recovery		Sulphide Mins		From (m)	To (m)	DESCRIPTION	Sample Data					
	0 %	100%	pyrite	chalcopyrite				From (m)	To (m)	Width (m)	Sample	Au (g/t)	Ag (g/t)
50													
55							54.27, 71.63 Fault zone, intensely fractured, bleached, sericite and chlorite altered, friable, brecciated, milled core; locally fault gouge. 68.10-68.33: 0.5% py in qtz/carb vein with 20% chlorite and actinolite fragments.	54.27	55.27	1.00	I006168	0.018	0.6
								55.27	56.27	1.00	I006169	0.015	0.2
								56.27	57.27	1.00	I006170	0.023	0.3
								57.27	58.27	1.00	I006171	0.007	<0.2
								58.27	59.27	1.00	I006172	0.007	<0.2
								59.27	60.27	1.00	I006173	0.009	<0.2
60								60.27	61.27	1.00	I006174	0.010	0.3
								61.27	62.27	1.00	I006175	0.007	0.2
								62.27	63.27	1.00	I006176	0.009	0.4
								63.27	64.27	1.00	I006177	0.008	0.2
								64.27	65.27	1.00	I006178	0.006	<0.2
65								65.27	66.27	1.00	I006179	0.008	0.2
								66.27	67.27	1.00	I006180	0.008	0.2

TROYMET EXPLORATION CORP.
GOLDEN EAGLE PROJECT
DIAMOND DRILL LOG

Depth (m)	Recovery		Sulphide Mins		From (m)	To (m)	DESCRIPTION	Sample Data					
	0 %	100%	0%	10%				From (m)	To (m)	Width (m)	Sample	Au (g/t)	Ag (g/t)
70								67.27	68.10	0.83	I006181	0.011	<0.2
								68.10	68.33	0.23	I006182	0.005	<0.2
								68.33	69.33	1.00	I006183	0.008	<0.2
								69.33	70.10	0.77	I006184	<0.005	<0.2
								70.10	71.10	1.00	I006185	0.009	0.2
								71.10	72.10	1.00	I006186	0.008	0.2
								72.10	73.10	1.00	I006187	0.008	0.3
								73.10	74.10	1.00	I006188	0.011	0.6
								74.10	75.21	1.11	I006189	0.006	0.3
75							75.21, 78.26 Tectonic Breccia zone, hematized, strongly silicified, very mottled texture, 1% py, 0.25% cpy, 20% brecciated chlorite/actinolite rich qtz/carb veining. 85.21-87.01: Tectonic Breccia zone, strongly silicified/silica flooded, 10-15% brown bte alt, mottled texture, 0.5% py, 15% brecciated chlorite/actinolite rich qtz/carb veining.	75.21	76.21	1.00	I006190	0.006	0.2
								76.21	77.21	1.00	I006191	0.007	0.5
								77.21	78.26	1.05	I006192	0.013	0.4
								78.26	79.26	1.00	I006193	0.006	0.2
								79.26	80.26	1.00	I006194	0.005	<0.2
80								80.26	81.26	1.00	I006195	<0.005	<0.2
								81.26	82.26	1.00	I006196	0.005	<0.2
								82.26	83.26	1.00	I006197	<0.005	<0.2
								83.26	84.26	1.00	I006198	<0.005	<0.2
85								84.26	85.21	0.95	I006201	<0.005	<0.2

TROYMET EXPLORATION CORP.
GOLDEN EAGLE PROJECT
DIAMOND DRILL LOG

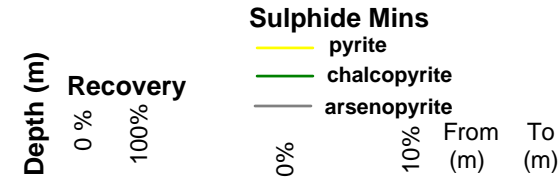

DESCRIPTION

Sample Data					
From (m)	To (m)	Width (m)	Sample	Au (g/t)	Ag (g/t)

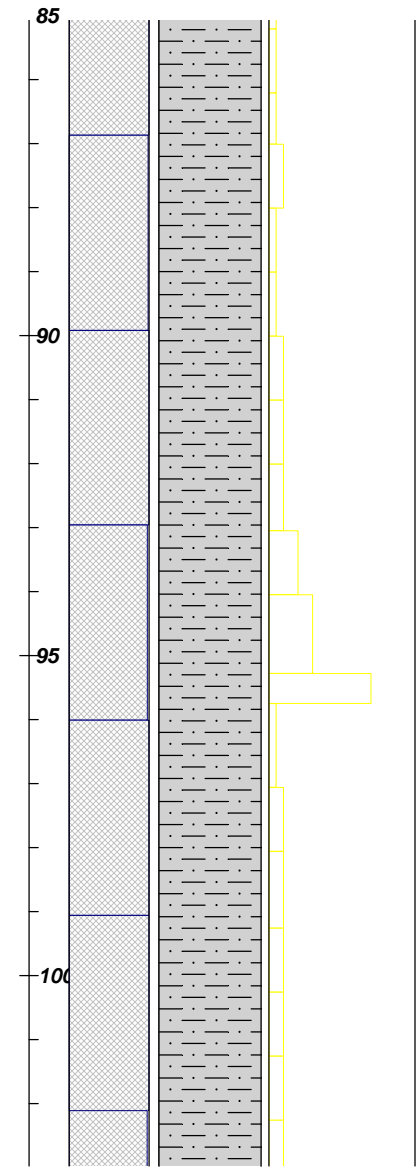

93.05, 104.61 Tectonic breccia/shear zone, strongly silicified/silica flooded, 20% brecciated and boudinaged curvilinear chlorite/actinolite rich qtz/carb veining, 2% py, locally 5-7% py.

85.21	86.21	1.00	I006202	0.005	<0.2
86.21	87.01	0.80	I006203	0.006	<0.2
87.01	88.01	1.00	I006204	0.009	0.2
88.01	89.01	1.00	I006205	0.008	<0.2
89.01	90.01	1.00	I006206	0.009	<0.2
90.01	91.01	1.00	I006207	0.019	0.2
91.01	92.01	1.00	I006208	0.009	<0.2
92.01	93.05	1.04	I006209	0.009	<0.2
93.05	94.05	1.00	I006210	0.006	<0.2
94.05	95.28	1.23	I006211	0.007	<0.2
95.28	95.75	0.47	I006212	0.007	<0.2
95.75	97.06	1.31	I006213	0.007	<0.2
97.06	98.06	1.00	I006214	0.023	<0.2
98.06	99.26	1.20	I006215	<0.005	<0.2
99.26	100.26	1.00	I006216	0.006	<0.2
100.26	101.26	1.00	I006217	0.006	<0.2
101.26	102.26	1.00	I006218	0.005	<0.2
102.26	103.26	1.00	I006219	0.006	<0.2

TROYMET EXPLORATION CORP.
GOLDEN EAGLE PROJECT
DIAMOND DRILL LOG

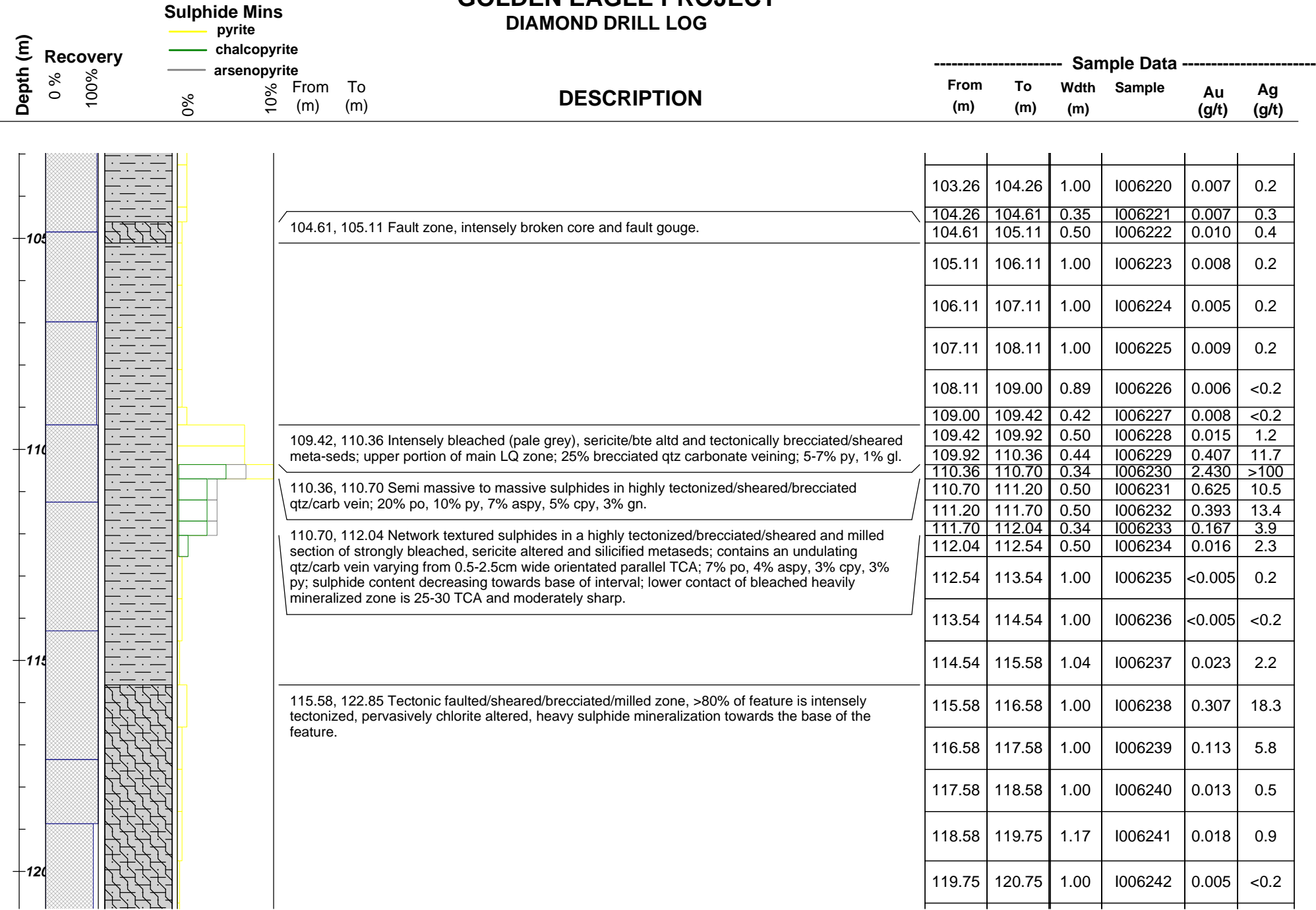

TROYMET EXPLORATION CORP.
GOLDEN EAGLE PROJECT
DIAMOND DRILL LOG

